

## Recommended mounting

direct mounting

using M8 screws

(it is also possible to fix the two halves separately)

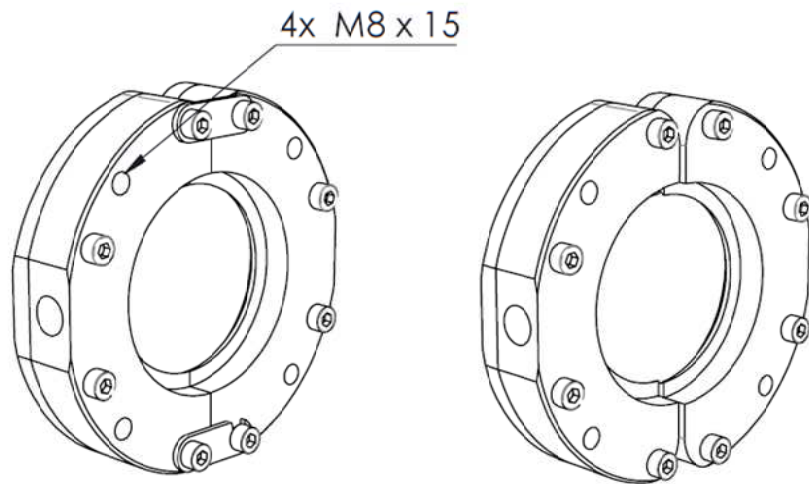

For opening the knife it is necessary to loosen the four screws M5 x 25

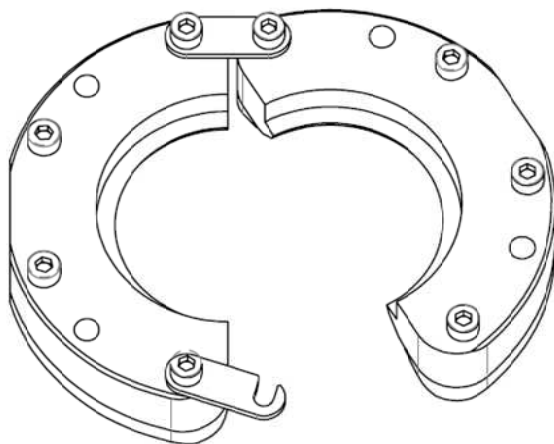

# VNCD

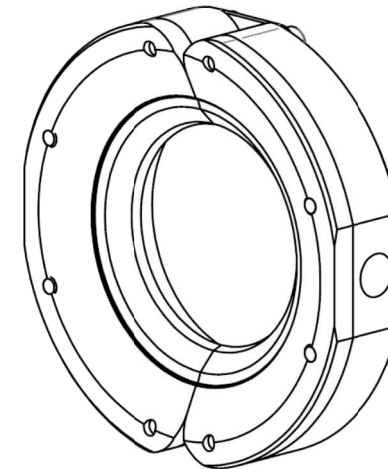

**MOS**  
technik

MOS technik s.r.o.

Jižní 724/14  
742 35 Odry

Czech Republic  
VAT: CZ29381045

Company office

Nádražní 29  
742 35 Odry

tel: +420 602 729 019  
e-mail: info@mostechnik.cz

# Technical details

## Compressed air source

connection: 2x G 1/4" side or back  
 max. pressure: 8 bar  
 filtered air: min. 25µm

side inlets

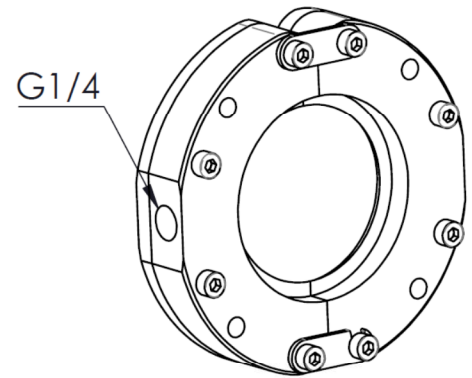

back inlets

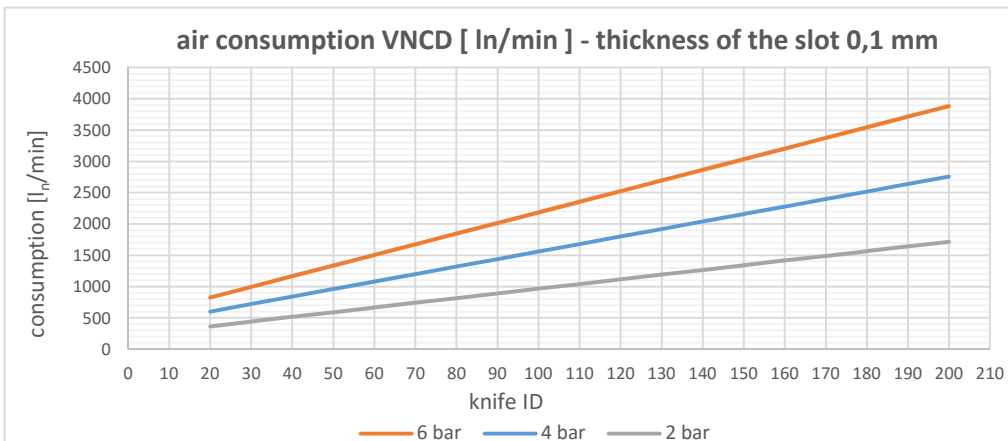
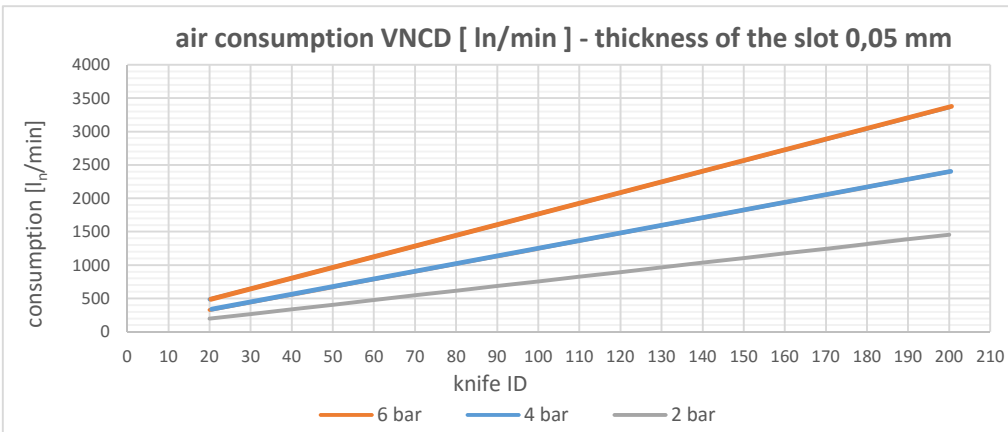
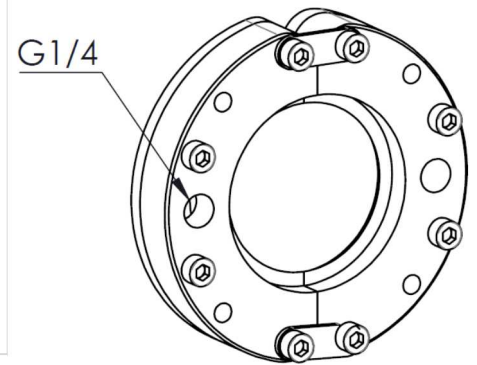

It is necessary to ensure sufficient supply of compressed air for correct function of the nozzle.

Inlet tubes and fittings must be designed to prevent large pressure losses.

## Planchet substitution

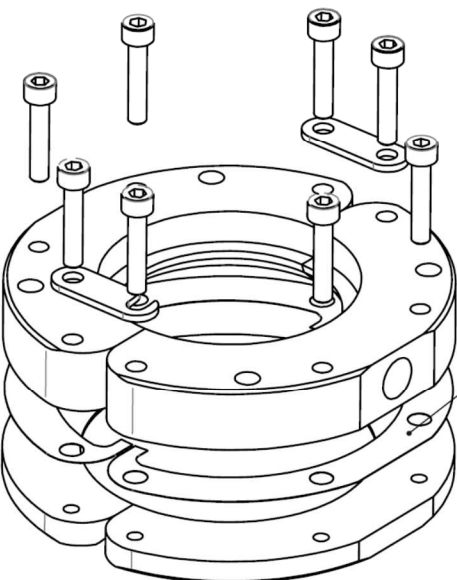

It is possible to increase the power of the air stream by planchet substitution. Planchettes are available with thicknesses: 0,05 mm and 0,08 mm. You can also adjust bigger thickness by combination of several planchettes.

Make sure that the **planchet is mounted in the correct position!**