

## Recommended mounting

Direct mounting  
on inlet tube

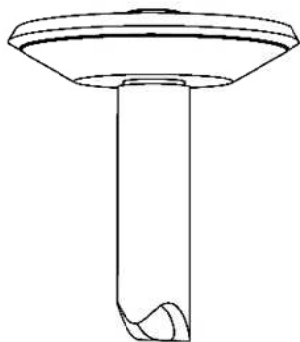

mounting on tubes  
mounting kit: **MS-VNCI-2-18**  
nebo **MS-VNCI-2-14**

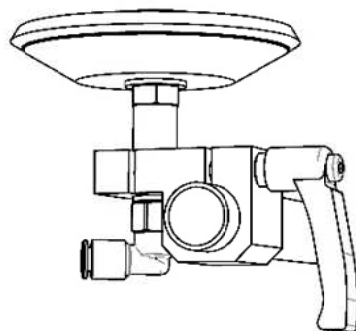

mounting on aluminium profiles  
mounting kit: **MS-VNCI-1-18**  
or **MS-VNCI-1-14**

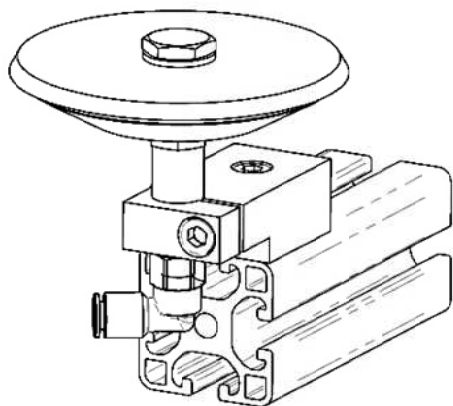

# VNCI

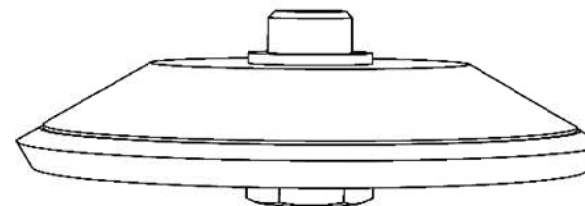

**MOS**  
technik

**MOS technik s.r.o.**  
Jižní 724/14  
742 35 Odry  
Czech Republic  
VAT: CZ29381045

**Company office**  
Nádražní 29  
742 35 Odry

tel: +420 602 729 019  
e-mail: [info@mostechnik.cz](mailto:info@mostechnik.cz)

# Technical details

## Compressed air source

connection:  $\phi D \leq 30 \text{ mm}$  1x G 1/8"  
 $\phi D > 30 \text{ mm}$  1x G 1/4"

max. pressure: 8 bar

filtered air: min. 25 $\mu\text{m}$

$\phi D \leq 30 \text{ mm}$  - 1 x - G1/8  
 $\phi D > 30 \text{ mm}$  - 1 x - G1/4

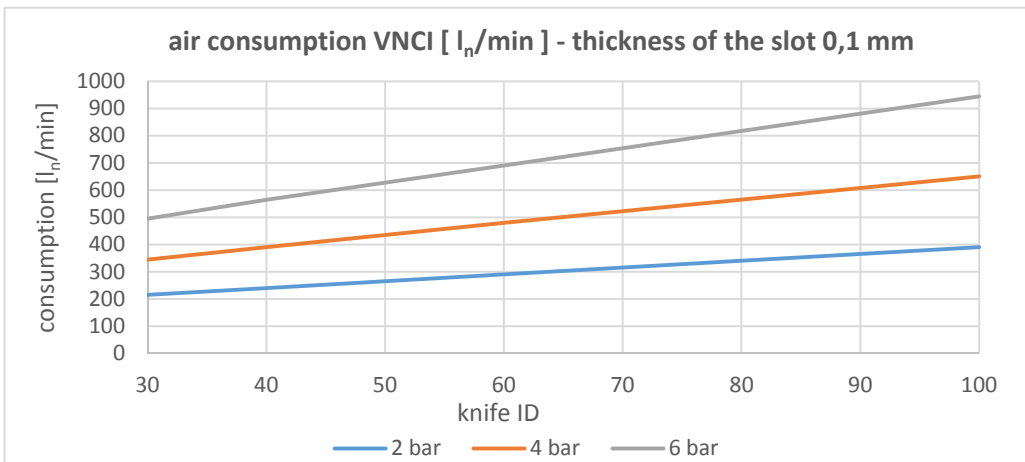
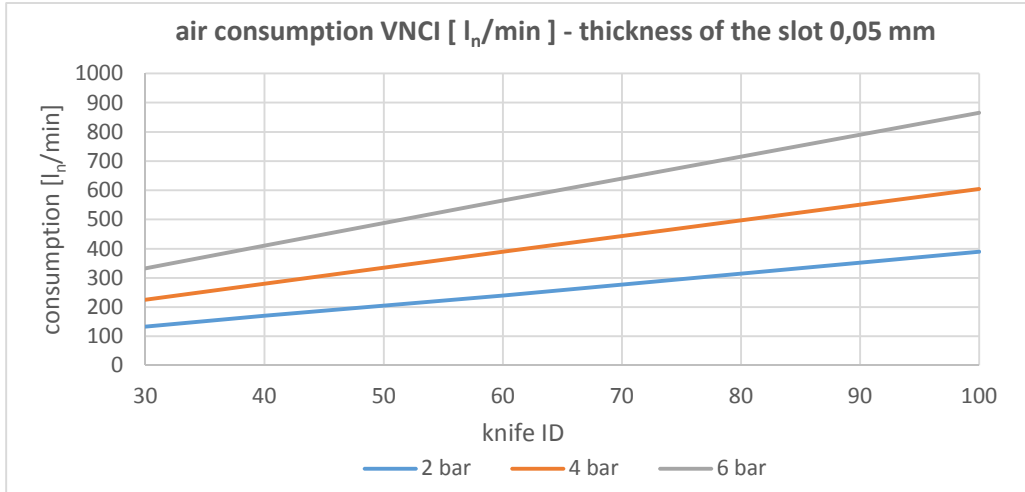
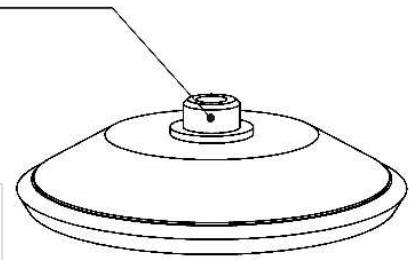

It is necessary to ensure sufficient supply of compressed air for correct function of the nozzle.

Inlet tubes and fittings must be designed to prevent large pressure losses.

## Planchet substitution

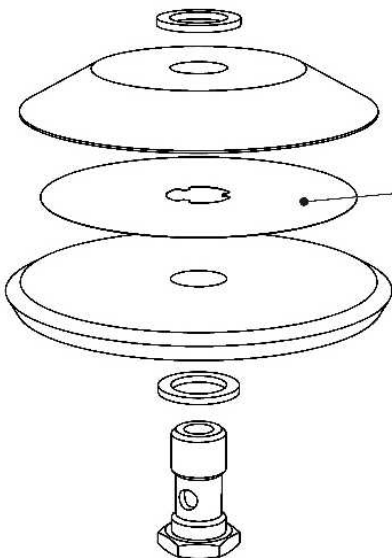

It is possible to increase the power of the air stream by planchet substitution. Planchettes are available with thicknesses: 0,05 mm and 0,08 mm. You can also adjust bigger thickness by combination of several planchettes.

Make sure that the **planchet is mounted in the correct position!**