

**AIR & STEAM FLAT FAN TIPS**

GZ air & steam flat fan tips are ideal for gas application. They are widely used in drying processes.

- **Typical applications:** water removal from surfaces, flocks and water blow off
- **Connection:** flanged nozzle tip

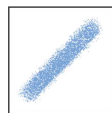
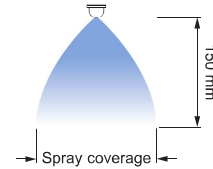
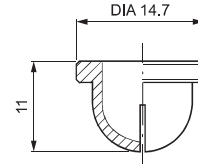

Spray section

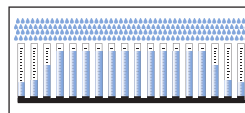

Distribution

Code	D mm	Air capacity (Nm <sup>3</sup> /hour) at different pressure values (bar)				Steam capacity (kg/hour) at different pressure values (bar)				Spray coverage		
		0.5 bar	2.0 bar	5.0 bar	10 bar	0.5 bar	2.0 bar	5.0 bar	10 bar	2.0 bar	5.0 bar	
70°	GZS 1300 xx	1.3	1.2	3.0	6.0	11.0	0.9	1.9	3.7	6.7	70	85
	GZS 1350 xx	1.5	2.0	3.5	7.1	12.6	1.0	2.1	4.1	7.7	72	87
	GZS 1500 xx	1.8	2.3	5.3	10.7	19.5	1.7	3.3	6.6	11.8	110	125
	GZS 1800 xx	2.1	3.2	8.0	16.0	29.0	2.5	5.0	9.9	18.0	115	140
	GZS 2150 xx	2.8	5.4	13.0	26.0	48.0	4.2	8.2	16.0	29.0	130	170
	GZS 2200 xx	3.6	8.9	21.7	43.3	79.4	6.8	13.6	27.0	48.0	140	180
GZS 2315 xx	4.3	13.0	31.8	65.6	120.2	10.3	20.6	40.4	73.0	170	215	

**ASSEMBLY FITTINGS**

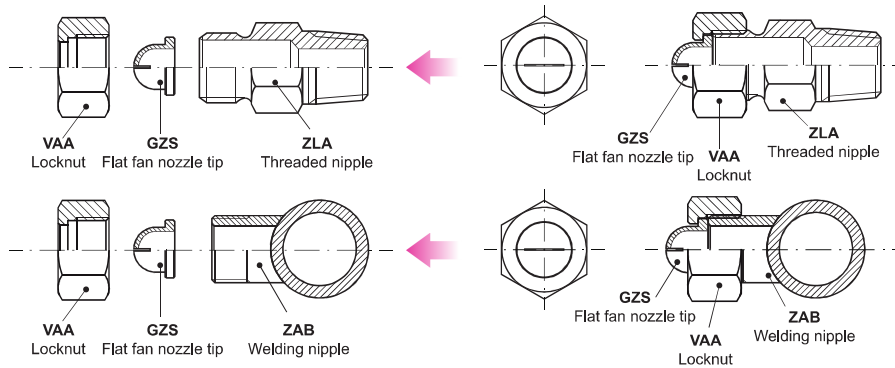
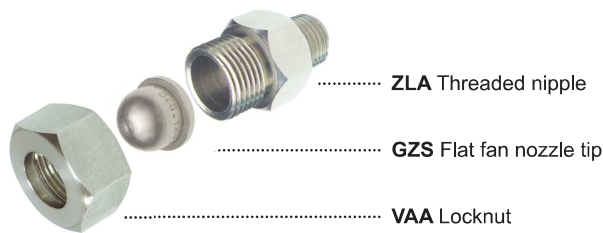

**HOW TO MAKE UP THE NOZZLE CODE**

EX.: GZS 1300 B1

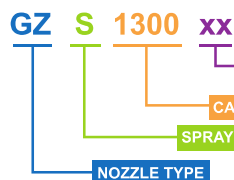

- MATERIAL**
- B1 - AISI 303 Stainless steel
  - B31 - AISI 316L Stainless steel
  - T1 - Brass